

REV.	LOOKS.	DESCRIPTION	DATE	DRAWN
01		INITIAL RELEASE.	2007.09.15	

Specifications

Current Rating: 3Amp
 Insulation Resistance: 1000M Min. Ω
 Dielectric Withstanding: 600V AC
 Contact Resistance: 20m Max Ω
 Operating Temperature: -40°C to +105°C

Materials

Contact Material: Brass
 Insulation Material: Polyester, UL 94V-0
 Nylon 6T

All materials must be GP materials

Recommended P.C.Board
 Hole Layout

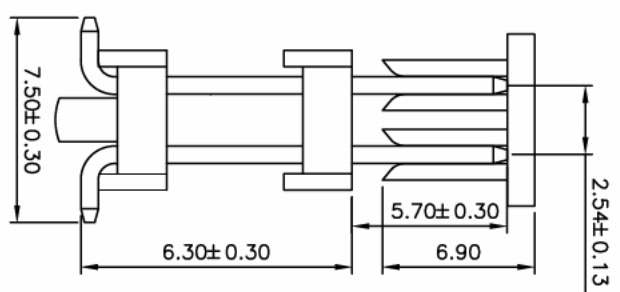
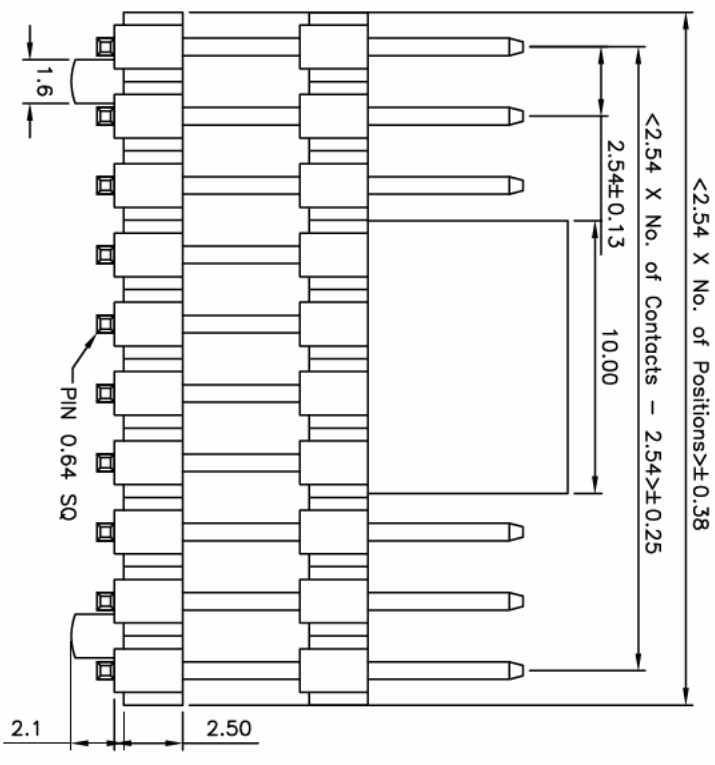
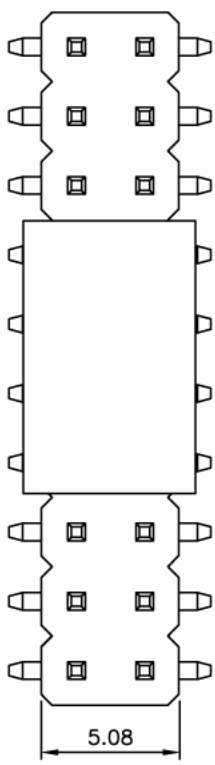
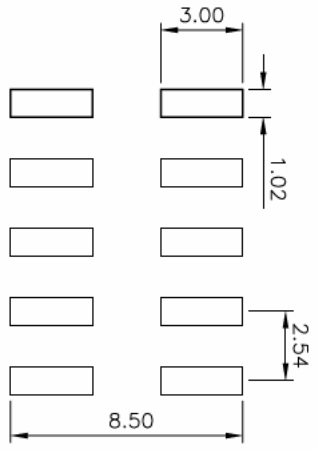

GENERAL TOLERANCE

X. ± 5.0°	X.	± 0.30
X. ± 3.0°	X	± 0.25
.XX ± 2.0°	.XX	± 0.15
.XXX ± 1.0°	.XXX	± 0.10

DESIGN:

CHECKED:	DATE:
AUDITED:	DATE:
APPROVED:	DATE:



PART NO. SM C02 2200 10 ED A:5.7
 H:12.0 W:PEG:CAP

TITLE:

Pin Header SMD Double Row
 Double Insulator 6.3mm,
 RM 2.54*2.54mm

REV.	UNIT.	SCALE.	PAGE.
01	mm	1:1	1/1



1 2 3 4 5 6 7 8 9