

4

3

2

1

REVISION DATA		
REV	DESCRIPTION	DATE
A0	NEW DRAWING	2018-05-15

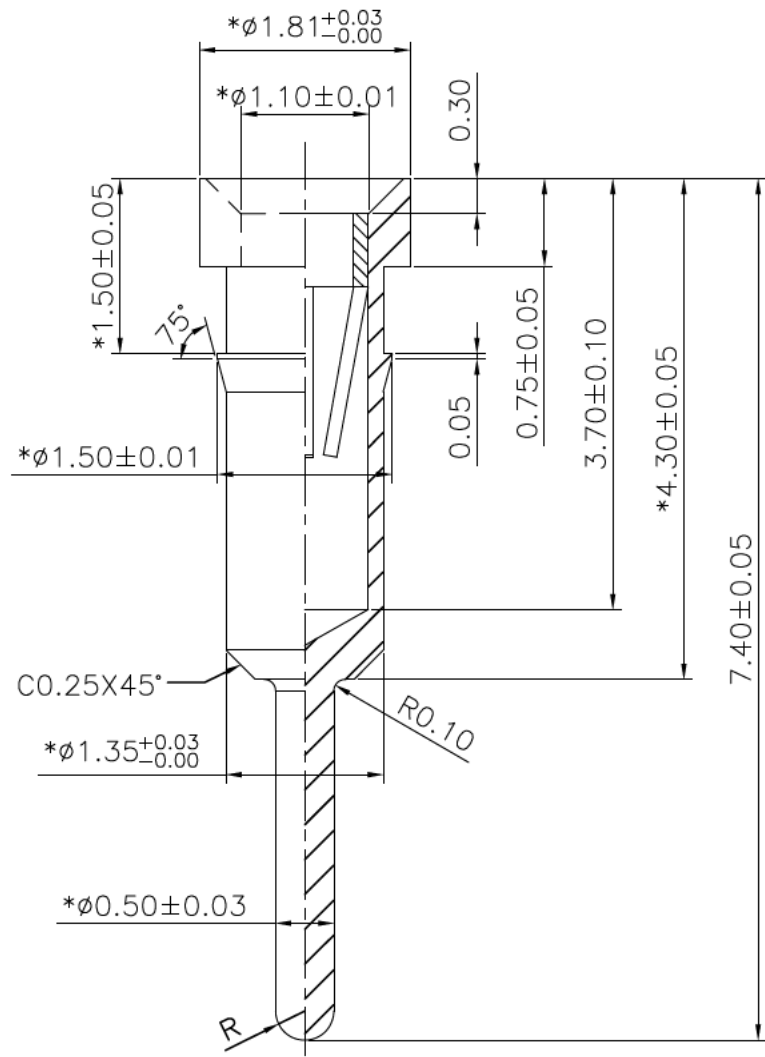

Technical Data

Material:
Pin(outer sleeve): Brass,machined CuZn38Pb2
Clip(contact 4/6 finger): Beryllium Copper,heat treated
Plating(outer sleeve):
 Tin plated: $2\mu\text{m}/80\mu\text{Ni}$, $5\mu\text{m}/200\mu\text{Sn}$
 Gold Plated: $2\mu\text{m}/80\mu\text{Ni}$, Full gold
 Plating(contact): $2\text{mm}/80\text{mNi}$, gold or Tin plated

Electrical
 Current rating: 3Amps/contact max.
 Contact resistance: $\leq 4\text{m}\Omega/\text{contact}$

Mechanical:
 Average insertion force with steel pin
 of $\phi 0.43\text{mm}/.017"$: 4 - finger < 250g , 6 - finger < 80g
 Average withdrawal force with steel pin
 of $\phi 0.43\text{mm}/.017"$: 4 - finger > 50g , 6 - finger > 25g
 Mechanical life cycle: min.200

TOLERANCE	PROJECTON				
ANGLE $\pm 5^\circ$	DATE :	2018-05-15			
X.XXX ± 0.05	DRAWN :				
X.XX ± 0.10	CHECKED :	DRAWING NO: SM C07-SAF42330740C			
X.X ± 0.15	APPROVED :	REV: A0	UNIT: mm	SCALE: 15:1	SIZE: A4
X. ± 0.20					

4

3

2

1