

Part Number	Wire Size	Current/Volt	Screw	Dimension (mm)					
				A	B	C	D (Pitch)	E	F
SM C09 710010 XX AK	2.5mm ²	24A/450V	M3.0*6	116.5	20.6	16.2	10.0	3.5	N/A
SM C09 710010 XX BK	2.5mm ²	24A/450V	M3.0*6	116.5	20.6	16.2	10.0	3.5	N/A
SM C09 710010 XX CK	2.5mm ²	24A/450V	M3.0*6	116.5	20.6	19.2	10.0	3.5	N/A
SM C09 710010 XX DK	2.5mm ²	24A/450V	M3.0*6	116.5	20.6	19.2	10.0	3.5	N/A

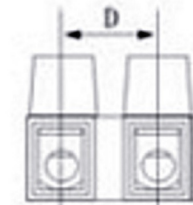
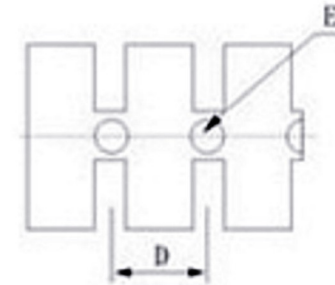
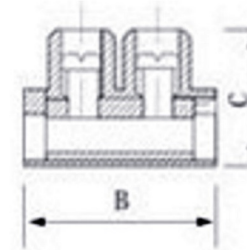
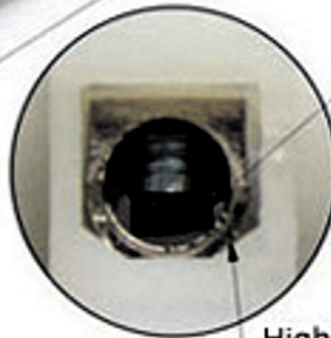

High Grade Copper Alloy (B Class)
Pure Copper Materials (A Class)

B = with wire protector
C = with Higher Base
D = Higher base and wire protector

Poles: 01-12P

RoHS Compliant		SCHMID-M	
APPD.		TOLERANCE	PART NAME
DWG.	BRAUN	0 ± .00 ± ANG. ±	Fuse Terminal Block
DATE	2013/05/14	UNIT M M	PART NO.
PAGE	1 OF 1	SIZE. A 4 REV. A	SM C09 710010 XX YK